

DOUBLER PLATES
(On all joints for added weld strength)

STANDARD RECESSED SMOOTH PLASTIC NET FASTENERS
(Fits all nets - no other parts to purchase. Will not injure players)

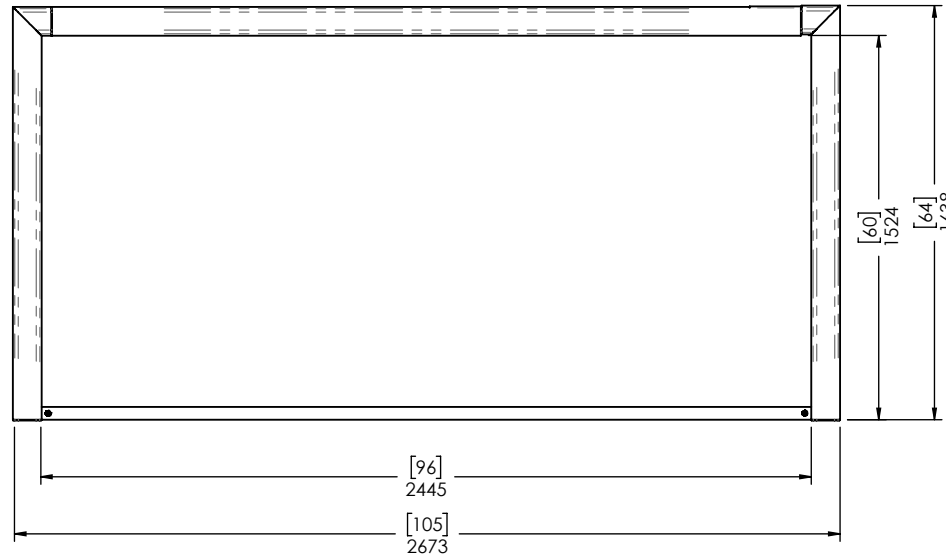

OVERALL DIMENSIONS

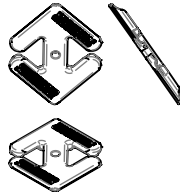
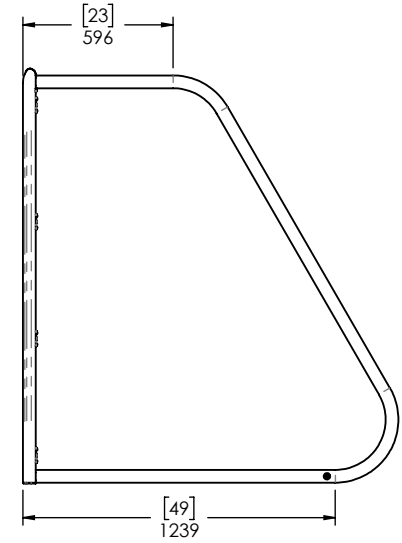

DEEP NET RACKS ADD STABILITY
(Goals won't tip over - Ground Anchors supplied as standard equipment)

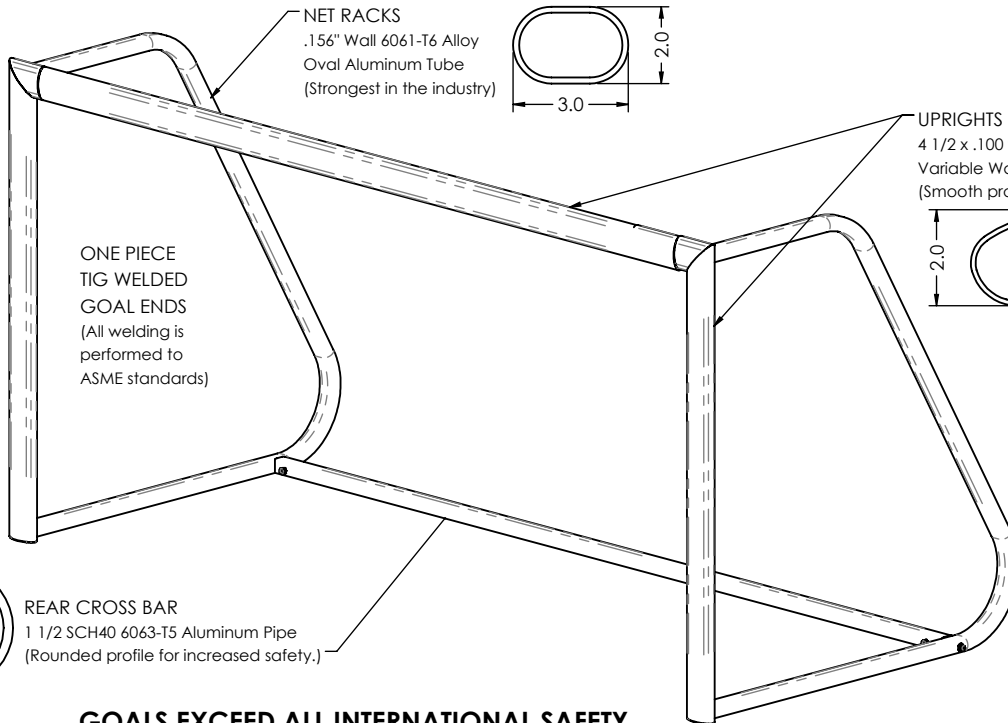

NET RACKS
.156" Wall 6061-T6 Alloy
Oval Aluminum Tube
(Strongest in the industry)

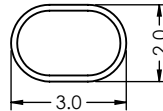

UPRIGHTS & UPPER CROSS BAR
4 1/2 x .100 to .125" 6061-T6 Alloy
Variable Wall Oval Aluminum D-Tube
(Smooth profile for increased safety)

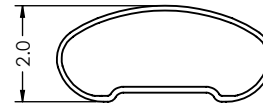

ONE PIECE TIG WELDED GOAL ENDS
(All welding is performed to ASME standards)

REAR CROSS BAR
1 1/2 SCH40 6063-T5 Aluminum Pipe
(Rounded profile for increased safety.)

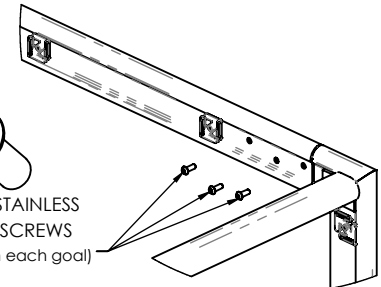

TAMPERPROOF STAINLESS STEEL ASSEMBLY SCREWS
(Tools Shipped with each goal)

BRIGHT ALUMINUM FINISH IS STANDARD
WHITE POWDER COAT PAINT AND NETS ARE
OPTIONAL. GOALS ARE SHIPPED KNOCKED
DOWN IN FOUR PARTS AND CAN BE EASILY
ASSEMBLED BY 2 PEOPLE IN MINUTES.
EASY TO MOVE BY 2 PEOPLE.

**GOALS EXCEED ALL INTERNATIONAL SAFETY
AND GAME STANDARDS - 5 YEAR WARRANTY
1 GOAL SET = TWO GOAL ENDS.**



1-888-726-7627 www.scoremaster.com

DM800 SOCCER GOAL SET