

DOUBLER PLATES  
(On all joints for added  
weld strength)

STANDARD RECESSED SMOOTH  
PLASTIC NET FASTENERS  
(Fits all nets - no other parts to  
purchase. Will not injure players)

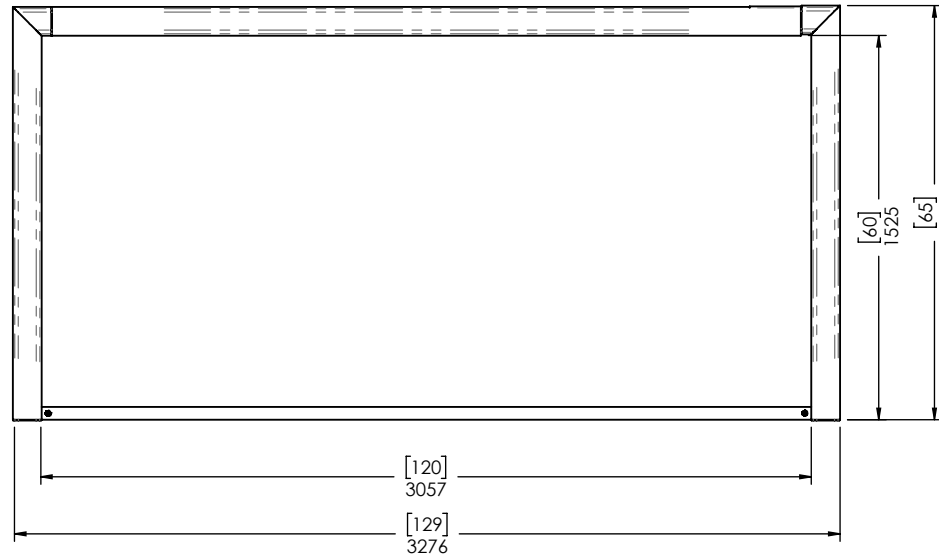
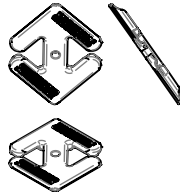

**OVERALL DIMENSIONS**

DEEP NET RACKS ADD STABILITY  
(Goals won't tip over - Ground Anchors  
supplied as standard equipment)

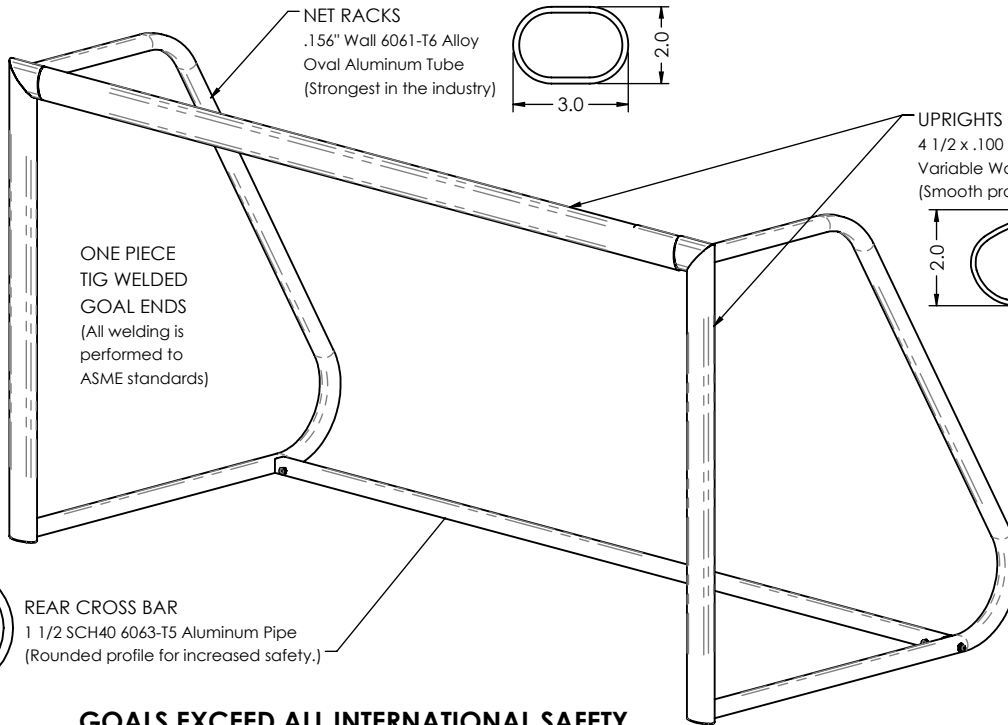

NET RACKS  
.156" Wall 6061-T6 Alloy  
Oval Aluminum Tube  
(Strongest in the industry)

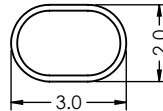

UPRIGHTS & UPPER CROSS BAR  
4 1/2 x .100 to .125" 6061-T6 Alloy  
Variable Wall Oval Aluminum D-Tube  
(Smooth profile for increased safety)

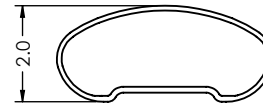

ONE PIECE  
TIG WELDED  
GOAL ENDS  
(All welding is  
performed to  
ASME standards)

REAR CROSS BAR  
1 1/2 SCH40 6063-T5 Aluminum Pipe  
(Rounded profile for increased safety.)

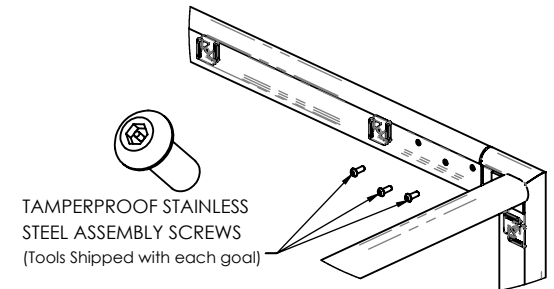
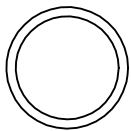

TAMPERPROOF STAINLESS  
STEEL ASSEMBLY SCREWS  
(Tools Shipped with each goal)

BRIGHT ALUMINUM FINISH IS STANDARD  
WHITE POWDER COAT PAINT AND NETS ARE  
OPTIONAL. GOALS ARE SHIPPED KNOCKED  
DOWN IN FOUR PARTS AND CAN BE EASILY  
ASSEMBLED BY 2 PEOPLE IN MINUTES.  
EASY TO MOVE BY 2 PEOPLE.

**GOALS EXCEED ALL INTERNATIONAL SAFETY  
AND GAME STANDARDS - 5 YEAR WARRANTY  
1 GOAL SET = TWO GOAL ENDS.**



1-888-726-7627 www.scoremaster.com

**DM1000 SOCCER GOAL SET**